

HG3Z4512AFCS

3X 4.5mm - 12.5mm F1.2
for 1/2" Format Cameras, Vari-focal Auto Iris VIDEO Drive
CS-Mount

with Focus and Amplifier

| | | | | | | | |
|----------------------------|---|-----------------|----------------|--------------------|---------------|-------------------------|---------------|
| Model No. | HG3Z4512AFCS | | Effective | Front | Ø19.0mm | | |
| Focal Length | 4.5mm - 12.5mm | | Lens Aperture | Rear | Ø10.3mm | | |
| Max. Aperture Ratio | 1:1.2 | | Back Focal | Tele | 18.3mm | | |
| Max. Image Format | 6.4mm x 4.8mm(Ø8mm) | | | Length | Wide | 9.9mm | |
| Operation Range | Iris | F1.2 - F360 | | Flange Back Length | | 12.5mm | |
| | Focus | 0.3m - Inf. | | Mount | | CS-Mount | |
| | Zoom | 4.5mm - 12.5mm | | Filter Size | | — | |
| Control | Iris | Auto Iris | | Dimensions | | Ø38.5mm x 48mm x 48.8mm | |
| | Focus | Manual | | Weight | | 65g | |
| | Zoom | Manual | | | | | |
| Object Dimension at M.O.D. | 4.5mm | 51.8cm x 34.9cm | | | | | |
| | 12.5mm | 16.1cm x 12.0cm | | | | | |
| Angle of View | D | 1/2" | 103.0° - 37.4° | 1/3" | 76.2° - 28.2° | 1/4" | 56.5° - 21.2° |
| | H | | 81.6° - 30.0° | | 60.4° - 22.6° | | 44.9° - 16.9° |
| | V | | 60.4° - 22.6° | | 45.0° - 17.0° | | 33.5° - 12.7° |
| Supply Voltage | DC8.5V - DC16V | | | | | | |
| Current | Less than 40mA | | | | | | |
| Response Time | Approx. 2 sec. | | | | | | |
| Light Weighting Method | Adjustable between Average - Peak (to be Set at Average at Factory) | | | | | | |
| Input Signal | Video Signal (V. or V.S.) | | | | | | |
| Iris Accuracy | ± 15% at Video Signal Level | | | | | | |
| Sensitivity Adjustment | 0.5V(p-p) - 1.0V(p-p) (Video Signal) | | | | | | |
| Input Impedance | High Impedance | | | | | | |
| Operating Temperature | -20°C - +50°C | | | | | | |

1/2"

CS

M.O.D. : Minimum Object Distance

Dimensions

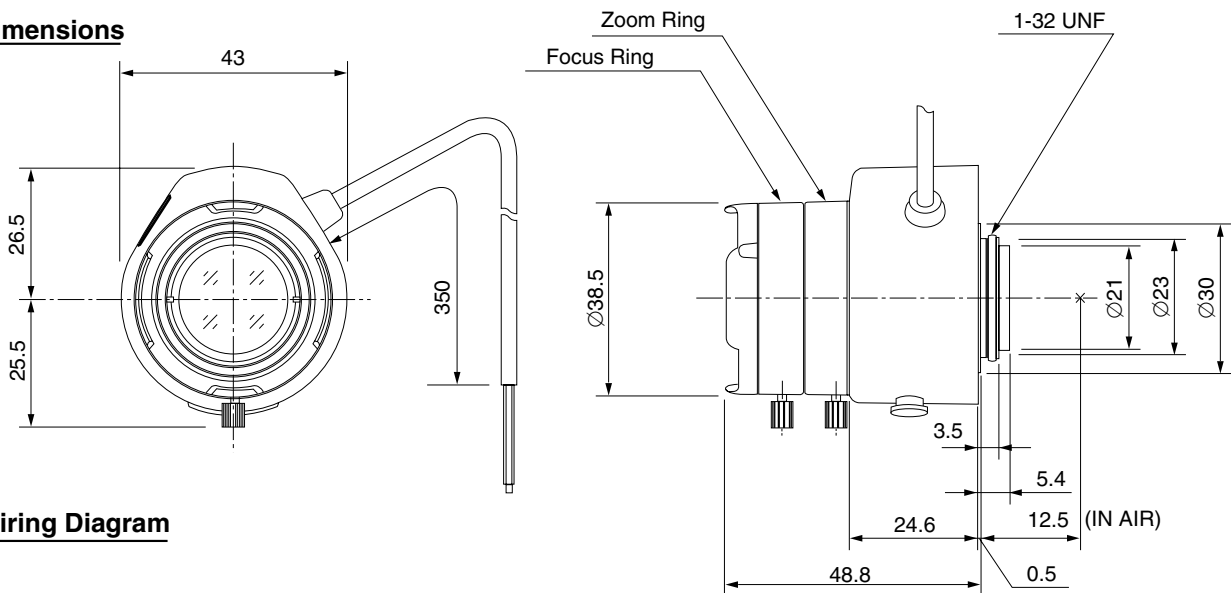

Wiring Diagram

