

EH100-8/EH100-10 Enclosure

INDOOR, SECURITY RATED, WALL/PEDESTAL MOUNT

Product Features

- Low Cost
- Indoor Applications
- Aluminum Construction
- Adjustable Camera Mount
- Wall or Pedestal Mounting
- Attractive, Rugged Powder Coat Finish
- Single Tamper-proof Screw Provides Quick Access and Increased Security



EH100-8 ENCLOSURE

The **EH100 Series** are low cost, light duty, indoor camera enclosures designed for use with various cameras on the market. These enclosures will accommodate fixed focal length lenses or motorized zoom lenses. All aluminum construction and rugged powder-coated surfaces make the **EH100 Series** a lightweight, attractive camera enclosure for most indoor applications.

The simple, interlocking clam-shell design with removable housing provides a fast, simple installation. Once installed, access to camera and lens only requires removal of one tamper-proof screw.

The **EH100 Series** enclosures have an adjustable camera sled that, when installed upside down, can also serve as an elevation block.

A knockout on the base of the enclosure provides the opening for all cabling or a 0.5-inch conduit connection.

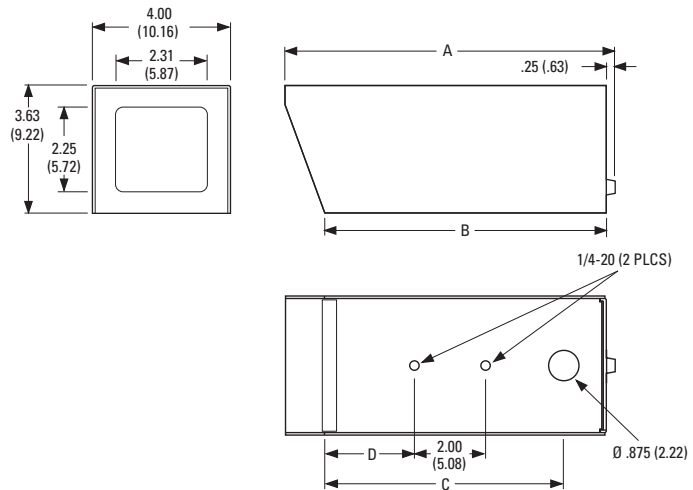

	A	B	C	D
EH100-8	9.25 (23.50)	8.00 (20.32)	6.81 (17.30)	2.59 (6.58)
EH100-10	11.25 (28.58)	10.00 (25.40)	8.81 (22.38)	3.59 (9.12)

NOTE: VALUES IN PARENTHESES ARE CENTIMETERS;
ALL OTHERS ARE INCHES.



DataFAX
SPEC: 21464
MANUAL: 214646

C1464 / REVISED 10-00

International Standards
Organization Registered
Firm ISO 9001 Quality System



TECHNICAL SPECIFICATIONS

MODEL

EH100-8	Security rated, indoor enclosure, 7.50-inch (19.05 cm) maximum length for camera, lens, and cable connections
EH100-10	Security rated, indoor enclosure, 9.50-inch (24.13 cm) maximum length for camera, lens and cable connections

MECHANICAL

Camera Mounting	Multiple holes on adjustable camera sled
Maximum Camera and Lens Size	Accepts camera and lens combinations* (including BNC connector) up to: EH100-8 2.75" H x 3.50" W x 7.50" L (6.99 x 8.89 x 19.05 cm) EH100-10 2.75" H x 3.50" W x 9.50" L (6.99 x 8.89 x 24.13 cm)
Viewing Window	.1875-inch (4.76 mm) thick Lexan®
Viewing Window Area	2.25" H x 2.31" W (5.72 x 5.87 cm)
Cable Entry	.875-inch (2.22 cm) diameter knockout; will accept 0.5-inch (1.27 cm) conduit fitting
Security	Tamper-resistant button head screw (hollow Allen wrench supplied)

*Assumes lens is fully extended.

GENERAL

Construction	Aluminum
Finish	Gray polyester powder coat
Environment	Indoor
Unit Weight	
EH100-8	1.35 lb (0.61 kg)
EH100-10	1.51 lb (0.68 kg)
Shipping Weight	
EH100-8	2 lb (.9 kg)
EH100-10	3 lb (1.35 kg)

RECOMMENDED MOUNTS

Ceiling/Pedestal

EM1009U, EM1015U	Medium duty ceiling/pedestal mount. Max. load 40 lb (18.12 kg).
EM3000	Ceiling "J" mount. Max. load 20 lb (9.06 kg).

Wall

EM1450	Light duty wall mount. Max. load 20 lb (9.06 kg).
EM1900U	Medium duty wall mount. Max. load 40 lb (18.12 kg).
EM2400	Light duty (indoor) wall mount. Max. load 20 lb (9.06 kg).



Pelco Worldwide Headquarters:

3500 Pelco Way, Clovis, California 93612-5699 USA

USA & Canada Tel: (800) 289-9100 • FAX (800) 289-9150 • DataFAX (800) 289-9108

International Tel: (559) 292-1981 • FAX (559) 348-1120 • DataFAX (559) 292-0435

www.pelco.com

LEXAN® is a registered trademark of the General Electric Company.
Specifications subject to change without notice.
©Copyright 2000, Pelco. All rights reserved.